



FIRST FLOOR



SECOND FLOOR



THIRD FLOOR

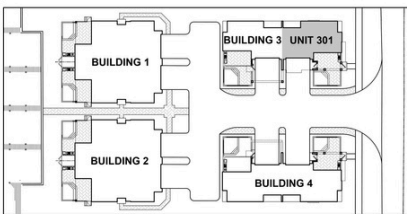

THE MOURNING DOVE
 BUILDING #3
 UNIT 301



FIRST FLOOR	
LIVING A/C	567 S.F.
ENTRY	34 S.F.
GARAGE	509 S.F.
COVERED LANAI	265 S.F.
COURTYARD (Pool and Deck)	247 S.F.
SECOND FLOOR	
LIVING A/C	1,230 S.F.
COVERED LANAI	308 S.F.
THIRD FLOOR	
LIVING A/C	1,257 S.F.
COVERED BALCONY	87 S.F.
TOTAL A/C	3,054 S.F.
COVERED GRAND TOTAL	4,257 S.F.